

## IBR-18 Bronze Accessible Feed Check Valve Flanged, Straight Inlet / Curved Inlet (IBR Approved)

### Product Description

HSN 84813000

Product : 'SANT' Bronze Accessible Feed Check Valve  
 Body Material cum Standard : Bronze IBR 282(a)(iv) Gr.B  
 Description : Right Angle Body Straight Inlet / Curved Inlet  
 Type of Seat : Renewable seat  
 Type of Disc : Renewable disc  
 Trim : SS AISI410 / Monel  
 Gland Packing : Expanded Pure Flexible Graphite  
 End Details : Flanges as per BS 10 Table H F.F. undrilled

### Testing & Certification

Hydraulic Test Pressure : 500 Psig.Hyd.  
 Working Pressure : Max.BOP 250 Psig.(17.58Kg/cm<sup>2</sup>)  
 Maximum Working Temperature : 435°F (225°C)

Test Certificate in Form III-C as per IBR is furnished with every supply.

### Application

Water	Steam
-------	-------



### Materials of Construction

Components	Materials	Specifications
Body, Bonnet, Check Nut & Gland	Bronze	IBR 282(a)(iv) Gr.B
Body Seat Ring, Valve Disc	S.S.	AISI-410
Stem	Stainless Steel	AISI-410
Gland Packing	Expanded Pure Flexible Graphite	—
Fasteners	Mild Steel	—
Handwheel	Cast Iron	IBR 86 to 93 Gr.A
Nut & Washer for Handwheel	Mild Steel	—

### Dimensions (in mm)

Nominal Size	Size (Inches)	A	B	H	W
20	3/4	65	125	120	70
25	1	115	150	140	100
32	1.1/4	112	160	160	115
40	1.1/2	102	142	203	125
50	2	102	170	203	145

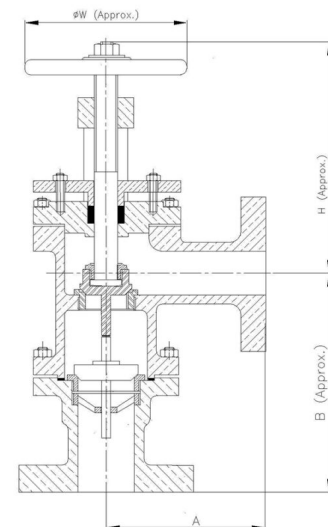

### Notes

1. Product images are for illustration purposes only. Actual product may vary.

2. Actual dimensions may change over time, due to continual design improvements. Please confirm before placing order.