

DH77X Double Door Wafer Check Valve PN16, UL Listed

Product Description

Product Certification

UL Listed (EX 16203)

Connection Ends

BS EN 1092 PN10/PN16, AS 2129

BS 10 Table D/E

Working Pressure

PN16

Temperature Range

0°C - 100°C

Coating

Fusion Bonded Epoxy Coating in accordance with ANSI/AWWA C550



Materials of Construction

Part No.	Part	Standard Specification
1	Valve Body	EN-GJS-450-10
2	Disc	SS316
3	Stem	SS420
4	Spring	SS304
5	Rubber Seat	EPDM

Dimensions (in mm)

Inch	mm	L	D	D1	D2
2"	50	54	106	68	46
2.5"	65	60	127	78	60
3"	80	57	134	102	70
4"	100	67	162	117	84
5"	125	83	194	145	115
6"	150	95	218	170	134
8"	200	127	277	226	184
10"	250	140	336	265	220
12"	300	181	406	310	260
14"	350	184	447	360	302
16"	400	191	505	410	350

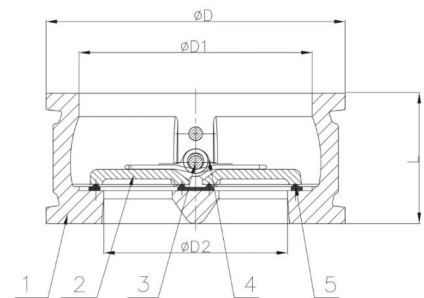

Notes

1. Product images are for illustration purposes only. Actual product may vary.
2. Actual dimensions may change over time, due to continual design improvements. Please confirm before placing order.