

IBR-9BS Bronze Controllable Feed Check Valve Straight, Flanged (IBR Approved)

Product Description

HSN 84813000

Product : 'SANT' Bronze Controllable Feed Check Valve
 Type of Pattern : Straight Type
 Body Material cum Standard : Bronze IBR 282(a)(iv) Gr.B
 Description : Screwed in Bonnet, OS Yoke Type , Rising Stem (15mm to 32mm)
 Bolted Bonnet, OS Yoke Type, Rising Stem (40mm to 50mm)
 Type of Seat : Renewable Seat
 Type of Disc : Renewable Disc
 Trim : SS AISI-410
 Gland Packing : Expanded Pure Flexible Graphite
 End Details : Flanges as per BS 10 Table H F.F. undrilled



Testing & Certification

Body Test Pressure : 500 Psig.Hyd.
 Seat Test Pressure : 500 Psig. Hyd. & 250 Psig. Steam
 Working Pressure : Max.BOP 250 Psig.(17.58Kg/cm²)
 Maximum Working Temperature: 225°C (435°F)

Test Certificate in Form III-C as per IBR is furnished with every supply.

Application

| | |
|-------|-------|
| Water | Steam |
|-------|-------|

Materials of Construction

| Components | Materials | Specifications |
|---------------------------------------|---------------------------------|---------------------|
| Body, Bonnet, Check Nut & Gland | Bronze | IBR 282(a)(iv) Gr.B |
| Body Seat Ring, Valve Disc & Stem | Stainless Steel | AISI-410 |
| Handwheel | Cast Iron | IBR 86 to 93 Gr.A |
| Gland Packing | Expanded Pure Flexible Graphite | — |
| Fasteners, Washer & Nut for Handwheel | Mild Steel | — |

Dimensions (in mm)

| Nominal Size | Nominal Size (Inches) | F | H (Approx.) | ØW (Approx.) |
|--------------|-----------------------|---------|-------------|--------------|
| 15 | 1/2 | 102±1.5 | 135 | 70 |
| 20 | 3/4 | 114±1.5 | 150 | 70 |
| 25 | 1 | 127±1.5 | 165 | 90 |
| 32 | 1.1/4 | 140±1.5 | 200 | 100 |
| 40 | 1.1/2 | 152±1.5 | 220 | 127 |
| 50 | 2 | 178±1.5 | 250 | 144 |

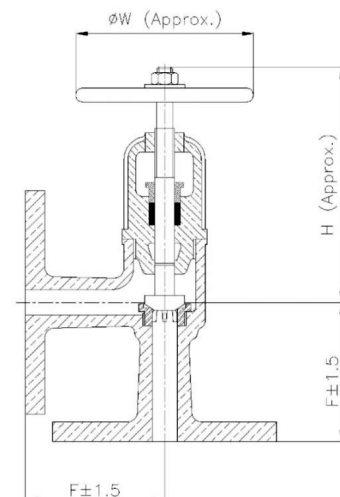

Notes

- Product images are for illustration purposes only. Actual product may vary.
- Actual dimensions may change over time, due to continual design improvements. Please confirm before placing order.