

## IBR-2C Bronze Globe Steam Stop Valve OS & Yoke Type, Flanged Ends (IBR Approved)

### Product Description

HSN 84818030

Product : 'SANT' Bronze Globe Steam Stop Valve  
 Type of Pattern : Straight Type  
 Body Material cum Standard : Bronze IBR 282(a)(iv) Gr.B  
 Description : Bolted Bonnet, Outside Screw & Yoke Type, Rising Stem  
 Type of Seat : Renewable Seat  
 Type of Disc : Renewable Disc  
 Trim : SS AISI-410  
 Gland Packing : Expanded Pure Flexible Graphite  
 End Details : Flanges as per BS 10 Table F F.F. undrilled



### Testing & Certification

Body Test Pressure : 300 Psig.Hyd.  
 Seat & Back Seat Test Pressure : 300 Psig. Hyd. & 150 Psig. Steam  
 Working Pressure : Max.BOP 150 Psig.(10.54Kg/cm<sup>2</sup>)  
 Maximum Working Temperature: 225°C (435°F)

Test Certificate in Form III-C as per IBR is furnished with every supply.

### Application

Water	Oil	Steam
-------	-----	-------

### Materials of Construction

Components	Materials	Specifications
Body, Bonnet, Disc Nut, Gland	Bronze	IBR 282(a)(iv) Gr.B
Stem, Body Seat Ring & Valve Disc	Stainless Steel	AISI-410
Handwheel	C.I. / D.I.	IBR 86 to 93 Gr.A
Gland Packing	Expanded Pure Flexible Graphite	—
Fasteners, Washer & Nut for Handwheel	Mild Steel	—

### Dimensions (in mm)

Nominal Size	Nominal Size (Inches)	F	H (Approx.)	ØW (Approx.)
15	1/2	95±1.5	135	70
20	3/4	108±1.5	150	70
25	1	118±1.5	165	90
32	1.1/4	127±1.5	200	90
40	1.1/2	143±1.5	220	127
50	2	171±1.5	250	144
65	2.1/2	225±1.5	270	178
80	3	264±1.5	325	197
100	4	289±1.5	345	229

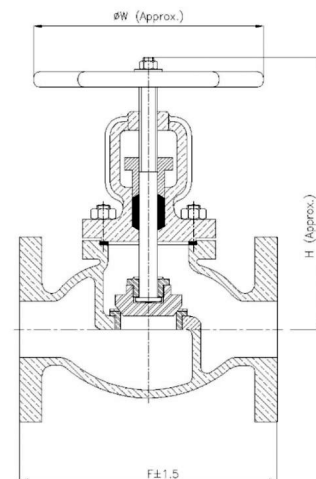

### Notes

- Product images are for illustration purposes only. Actual product may vary.
- Actual dimensions may change over time, due to continual design improvements. Please confirm before placing order.