

CIBFP C.I. Butterfly Valve with Pneumatic Actuator Wafer Type, PN 10/PN 16

Product Description

HSN 84818030

Product : Sant C.I. Butterfly Valve with Pneumatic Actuator
 Type of Pattern : Water Type
 Pressure/Class/Rating : PN 10/PN 16
 Body Material Cum Standard : CI to IS:210 Gr FG200
 Product Description : Wafer Type
 Type of Seat : Nitrile/EPDM Lining
 Type of Disc : Stainless Steel CF8
 Stem : AISI-410
 End Details : Suitable insertion between flanges as per BS 10 Table F/D/E or ASME B 16.1 Class-125



Testing & Certification

Ratings:

PN10

Body Test Pressure : 1.5MPa (218 Psig) Hyd

Seat Test Pressure : 1.1MPa (160 Psig) Hyd

PN16

Body Test Pressure : 2.4MPa (348 Psig) Hyd

Seat Test Pressure : 1.8MPa (261 Psig) Hyd

Materials of Construction

| Components | Materials | Specifications |
|--------------------|---------------------|-----------------|
| Bush | PTFE | |
| Body | Cast Iron | IS:210:Gr.FG200 |
| Upper Stem | SS | AISI-410 |
| Cover Plate | Carbon Steel | |
| Body Lining | EPDM/Nitrile Rubber | |
| Disc | SS | CF8 |
| Lower Stem | SS | AISI-410 |
| Locking Screw | Steel | |
| Bolts & Nuts | Carbon Steel | |
| Pneumatic Actuator | | |

Dimensions (in mm)

| Size | F±2 | D |
|------|-----|-----|
| 40 | 33 | 82 |
| 50 | 43 | 95 |
| 65 | 46 | 106 |
| 80 | 46 | 124 |
| 100 | 52 | 150 |
| 125 | 56 | 174 |
| 150 | 56 | 210 |
| 200 | 60 | 260 |

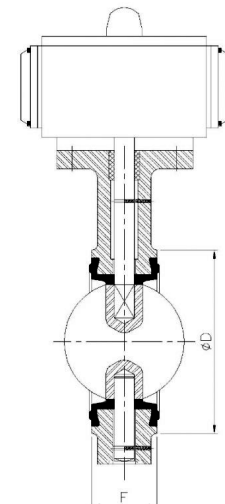

Notes

1. Product images are for illustration purposes only. Actual product may vary.
2. Actual dimensions may change over time, due to continual design improvements. Please confirm before placing order.