

BBVF Brass Ball Valve with Flare Nut Screwed

Product Description

HSN 90282000

Product : Sant Brass Ball Valve with Flare Nut
 Type of Pattern : Two Pcs design with Lever Operated and Flare Nut
 Body & Bonnet : Brass
 Type of Ball : Brass Chrome Plated
 Type of Seats : PTFE Renewable Seats
 Stem : Brass
 Packing : PTFE
 End Details : Screwed end BSP Female Threads and one end with Swivel Nut (End connection 5/8")



Testing & Certification

Body Test Pressure : 20kg/cm²g (Hyd.)
 Seat Test Pressure : 13.5kg/cm²g (Hyd.)

Materials of Construction

| Components | Materials | Specifications |
|--------------------|--------------------|----------------|
| Nut | S.S. | - |
| Gland | Brass | - |
| Gland Seal | PTFE | - |
| Body of Ball Valve | Brass | - |
| Seat | PTFE | - |
| Ball | Brass | - |
| Stem | Brass | - |
| Flare Nut | Brass | - |
| Lever | M.S (Power Coated) | - |

Dimensions (in mm)

| Size | F | LL | T |
|------|----|-----|----------|
| 20 | 77 | 100 | 3/4" BSP |
| 25 | 77 | 100 | 1" BSP |

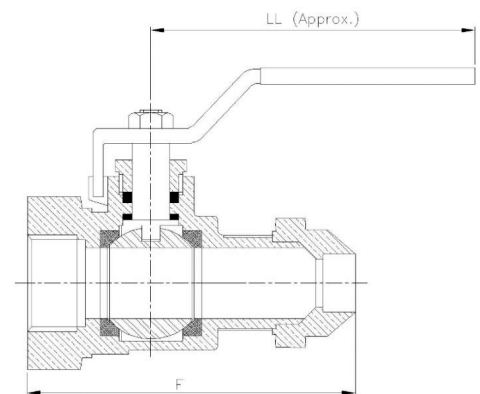

Notes

1. Product images are for illustration purposes only. Actual product may vary.
2. Actual dimensions may change over time, due to continual design improvements. Please confirm before placing order.