

IS-14A Bronze Horizontal Lift Check Valve Screwed, IS : 778 Class-2 (ISI Marked)

Product Description

HSN 84813000

Product : 'SANT' Bronze Horizontal Lift Check Valve
 Product Standard : IS-778
 Pressure/Class/Rating : Class-2
 Body Material cum Standard : GM (IS:318 Gr.LTB2)
 Description : Screwed in Cover
 Type of Seat : Integral seat
 Trim : Cu-Alloy
 End Details : Screwed female threads to IS:554 Parallel

Testing & Certification

Body Test Pressure : 2.4 MPa Hyd.
 Seat Test Pressure : 1.6 MPa Hyd.
 Max Working Temperature: 45°C

Our Works' Test Certificate is furnished with every supply.



Application

Water	Oil
-------	-----

Materials of Construction

Components	Materials	Specifications
Body, Bonnet & Valve Disc	Leaded Tin Bronze	IS:318 Gr.LTB2

Dimensions (in mm)

Nominal Size	Nominal Size (Inches)	F	H (Approx.)
15	1/2	60±1.5	36
20	3/4	70±1.5	40
25	1	80±1.5	51
32	1.1/4	95±1.5	60
40	1.1/2	110±1.5	70
50	2	125±1.5	75
65	2.1/2	160±1.5	90
80	3	180±1.5	102
100	4	216±1.5	125

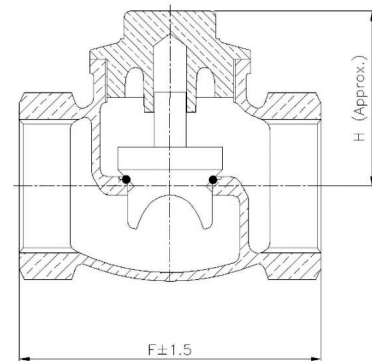

Notes

- Product images are for illustration purposes only. Actual product may vary.
- Actual dimensions may change over time, due to continual design improvements. Please confirm before placing order.