

IS-13 Bronze Globe Valve Rising Stem, Screwed, As Per IS : 778 : 1971 Class-3

Product Description

HSN 84818030

Product : 'SANT' Bronze Globe Valve
Product Standard : As Per IS-778:1971
Pressure/Class/Rating : Class-3
Body Material cum Standard : GM (IS:318 Gr.LTB2)
Description : Screwed in Bonnet, Inside Screw, Rising Stem
Type of Seat : Integral seat
Trim : Cu-Alloy
Gland Packing : PTFE
End Details : Screwed female threads to IS:554 Parallel

Testing & Certification

Body Test Pressure : 50 Kg/cm² Hyd.
Seat & Back Seat Test Pressure : 40 Kg/cm² Hyd.
Max Working Temperature: 45°C

Our Works' Test Certificate is furnished with every supply.

Application

Water	Oil
-------	-----



Materials of Construction

Components	Materials	Specifications
Body, Bonnet, Disc, Gland & Gland Nut, Disc Nut	Leaded Tin Bronze	IS:318 Gr.LTB2
Stem	Forged Brass	IS:6912 Gr.FLB
Handwheel	Cast Iron / Steel	IS:210 Gr.FG200
Gland Packing	PTFE	—
Screw & Washer for Handwheel	Mild Steel	—

Dimensions (in mm)

Nominal Size	Nominal Size (Inches)	F	H (Approx.)	ØW (Approx.)
15	1/2	89±1.5	90	60
20	3/4	100±1.5	110	65
25	1	117±1.5	120	80
32	1.1/4	133±1.5	130	90
40	1.1/2	150±1.5	150	145
50	2	178±1.5	180	175
65	2.1/2	200±1.5	210	195
80	3	250±1.5	226	195
100	4	300±1.5	250	230

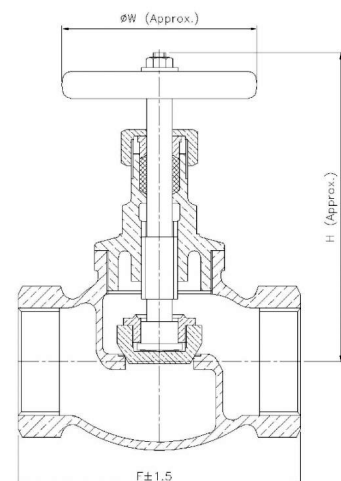

Notes

- Product images are for illustration purposes only. Actual product may vary.
- Actual dimensions may change over time, due to continual design improvements. Please confirm before placing order.