

FSV-1B Forged Steel Gate Valve Reduced Bore, Class 800, Socket Welded Ends (IBR Approved)

Product Description

HSN 84818030

Product : 'SANT' Forged Steel Gate Valve
 Product Standard : BS 5352 / API 602
 Pressure / Class / Rating : Class 800
 Type of Pattern : Straight Type
 Body Material cum Standard : FCS (A105)
 Description : Bolted Bonnet, Outside Screw & Yoke Type, Rising Stem
 Type of Seat : Renewable Seat
 Type of Disc : Renewable Disc
 Trim : SS AISI-410
 Gland Packing : Expanded Pure Flexible Graphite
 Fastener & Gasket : Alloy Steel (Gr.B7/2H) Spiral Wound SS 304 (CAF/Graphite filled)
 End Details : Socket Welded Ends as per ASME B-16.11



Testing & Certification

Body Test Pressure : 207 Bar g (3000 Psig) Hyd.
 Seat Test Pressure : 152 Bar g (2200 Psig) Hyd. & 6.9 Bar g (100 Psig) Air
 Maximum Working Temperature : 425°C

Test Certificate in Form III-C as per IBR is furnished with every supply

Application

Water	Oil	Steam
-------	-----	-------

Materials of Construction

Components	Materials	Specifications
Body, Bonnet, Gland Flange	Drop Forged C.Steel	ASTM A105
Body Seat Ring, Wedge, Gland, Stem, Gland Eye Bolts, Yoke Sleeve	Stainless Steel	AISI-410
Gland Packing	Expanded Pure Flexible Graphite	—
Gasket	Spiral Wound SS (AISI-304) Asbestos Filled / Graphite Filled	—
Handwheel	Malleable Iron / D.I.	IS:14329
Studs / Bolts	Alloy Steel	ASTM A193 Gr.B7
Nuts	High Tensile Steel	ASTM A194 Gr.2H
Gland Nuts, Screw, Wheel Nuts & Washer	Mild Steel	—

Dimensions (in mm)

Nominal Size	Nominal Size (Inches)	F	H (Approx)	W (Approx)	A (Min.)	B (Min.)	B (Max.)
10	3/8	73±2	130	86	10	17.6	18
15	1/2	73±2	135	86	10	21.8	22.2
20	3/4	80±2	137	86	13	27.1	27.5
25	1	100±2	162	116	13	33.8	34.2
40	1.1/2	120±2	201	150	13	48.6	49.1
50	2	130±2	223	150	16	61.1	61.6

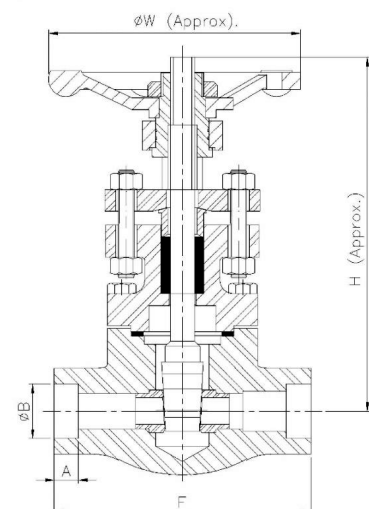

Notes

1. Product images are for illustration purposes only. Actual product may vary.
2. Actual dimensions may change over time, due to continual design improvements. Please confirm before placing order.