

CR-21B Cast Iron Butterfly Valve Wafer Type (ISI Marked)

Product Description

HSN 84818030

Product : 'SANT' Cast Iron Butterfly Valve
 Type of Pattern : Medium Pattern
 Product Standard : IS:13095
 Pressure / Class / Rating : PN 10/PN 16
 Body Material cum Standard : Cast Iron IS:210 Gr.FG200
 Description : Wafer Type
 Type of Seat : Nitrile / EPDM Lining
 Type of Disc : SG Iron
 Trim : SS AISI-410
 End Details : Suitable insertion between Flanges as per BS 10 Table D/E ANSI B 16.1 CI-125



Testing & Certification

Ratings:

PN10
 Body Test Pressure : 1.5MPa (218 Psig) Hyd
 Seat Test Pressure : 1.1MPa (160 Psig) Hyd

PN16
 Body Test Pressure : 2.4MPa (348 Psig) Hyd
 Seat Test Pressure : 1.8MPa (261 Psig) Hyd

Our Works' Test Certificate is furnished with every supply.

Application

Water

Materials of Construction

| Components | Materials | Specifications |
|-------------------|-----------------|---------------------------|
| Body | Cast Iron | IS:210 Gr.FG260 |
| Disc | S.G. Iron | IS:1865 Gr.SG400/15 |
| Shaft | Stainless Steel | AISI-410/ IS:6603: 12cr12 |
| Seat | Rubber Lining | Nitrile / EPDM Lining |
| Gear | MS | — |
| Lever / Handwheel | M.S. / D.I. | — |

Dimensions (in mm)

| Nominal Size | Nominal Size (Inches) | F | ØD | H (Approx.) | ØW (Approx.) |
|--------------|-----------------------|-------|-----|-------------|--------------|
| 200 | 8 | 60±2 | 260 | 335 | 240 |
| 250 | 10 | 68±2 | 315 | 375 | 240 |
| 300 | 12 | 78±3 | 375 | 404 | 285 |
| 350 | 14 | 92±3 | 418 | 475 | 355 |
| 400 | 16 | 102±3 | 470 | 505 | 355 |
| 450 | 18 | 114±3 | 525 | 580 | 450 |
| 500 | 20 | 127±3 | 575 | 625 | 625 |
| 600 | 24 | 154±3 | 693 | 700 | 625 |

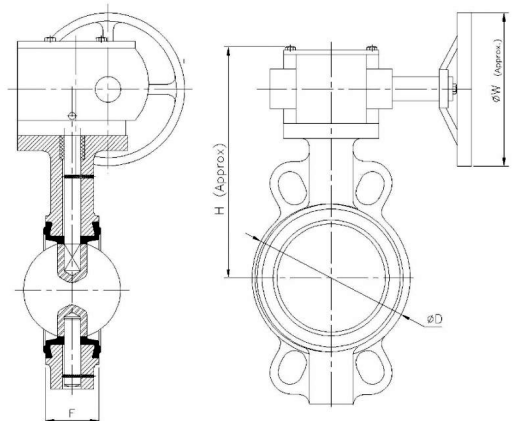

Notes

1. Product images are for illustration purposes only. Actual product may vary.
2. Actual dimensions may change over time, due to continual design improvements. Please confirm before placing order.