

## CI-5B Cast Iron Accessible Feed Check Valve Flanged, without Inspection Branch (IBR Approved)

### Product Description

HSN 84813000

Product : 'SANT' Cast Iron Accessible Feed Check Valve  
 Type of Pattern : Right Angle  
 Body Material cum Standard : Cast Iron IBR 86 to 93 Gr.A  
 Description : Curved Inlet without Inspection Branch  
 Type of Seat : Renewable seat  
 Type of Disc : Renewable disc  
 Trim : SS AISI-410  
 Gland Packing : Expanded Pure Flexible Graphite  
 End Details : Flanges as per BS 10 Table F F.F. undrilled



### Testing & Certification

TABLE - F

Body Test Pressure : 21.09Kg/cm<sup>2</sup>g  
 Seat & Backseat Test Pressure : 10.54Kg/cm<sup>2</sup>g  
 Working Pressure : Max BOP 10.54Kg/cm<sup>2</sup>g (150 Psig.) at 220°C Steam

Test Certificate in Form III-C as per IBR is furnished with every supply.

### Application

Water	Steam
-------	-------

### Materials of Construction

Components	Materials	Specifications
Body, Bonnet, Valve Disc, Gland & Handwheel	Cast Iron	IBR 86 to 93 Gr.A
Body Seat Ring, Valve Disc Rings & Check Nut	Stainless Steel	AISI-410
Stopper & Drain Plug	Bronze	IBR 282(a)(iv) Gr.B
Gasket	Compressed Asbestos Fiber	IS:2712 Gr.C
Gland Packing	Expanded Pure Flexible Graphite	—
Fasteners	Mild Steel	—
Yoke Bush	Bronze	—

### Dimensions (in mm)

Nominal Size	Nominal Size (Inches)	B±2	C	F	G±2	ØW
25	1	220	180	95	100	125
32	1.1/4	240	190	105	105	125
40	1.1/2	260	200	110	115	160
50	2	280	210	120	125	160
65	2.1/2	300	250	130	145	200

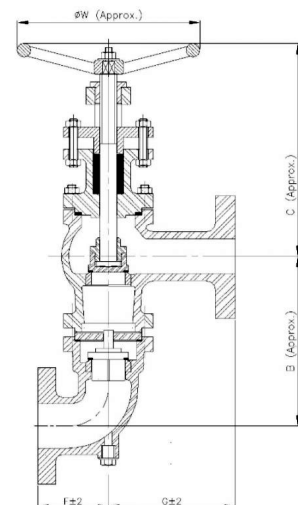

### Notes

1. Product images are for illustration purposes only. Actual product may vary.

2. Actual dimensions may change over time, due to continual design improvements. Please confirm before placing order.