

CI-5A Cast Iron Accessible Feed Check Valve Flanged, without Inspection Branch (IBR Approved)

Product Description

HSN 84813000

Product : 'SANT' Cast Iron Accessible Feed Check Valve
 Type of Pattern : Right Angle
 Body Material cum Standard : Cast Iron IBR 86 to 93 Gr.A
 Description : Straight Inlet without Inspection Branch
 Type of Seat : Renewable seat
 Type of Disc : Renewable disc
 Trim : SS AISI-410
 Gland Packing : Expanded Pure Flexible Graphite
 End Details : Flanges as per BS 10 Table F & H F.F. undrilled



Testing & Certification

TABLE - F

Body Test Pressure : 21.09Kg/cm²
 Seat & Backseat Test Pressure : 10.54Kg/cm²
 Working Pressure : Max BOP 10.54Kg/cm² (150 Psig.) at 220°C Steam

TABLE - H

Body Test Pressure : 26Kg/cm²
 Seat & Backseat Test Pressure : 13Kg/cm²
 Working Pressure : Max BOP 13Kg/cm² (185 Psig.) at 220°C Steam

Test Certificate in Form III-C as per IBR is furnished with every supply.

Application

Water	Steam
-------	-------

Materials of Construction

Components	Materials	Specifications
Body, Bonnet, Valve Disc, Gland & Handwheel	Cast Iron	IBR 86 to 93 Gr.A
Body Seat Ring, Valve Disc Rings & Check Nut	Stainless Steel	AISI-410
Gasket	Compressed Asbestos Fiber	IS:2712 Gr.C
Gland Packing	Expanded Pure Flexible Graphite	—
Fasteners	Mild Steel	—
Yoke Bush	Aluminum Bronze	—

Dimensions (in mm)

Nominal Size	Nominal Size (Inches)	B±2	C (Closed)	G±2	ØW
25	1	225	180	100	125
32	1.1/4	240	190	105	125
40	1.1/2	265	210	115	160
50	2	280	220	125	160
65	2.1/2	300	250	145	200

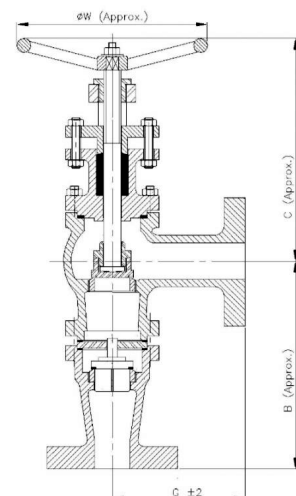

Notes

1. Product images are for illustration purposes only. Actual product may vary.
2. Actual dimensions may change over time, due to continual design improvements. Please confirm before placing order.